



SIDE STEP CARD

SUPPLIES & TOOLS

- 7-in. x 10-in. Cardstock – card base
- Score Board #30195075
- Paper Trimmer #30174692
- Embellishments – stamped images, stickers, additional cardstock for layering, buttons, etc.
- Double-stick Tape #30013284
- Aleene's Fast Grab Tacky Glue #30172710
- Scissors
- 5-in x 7-in. Card Envelope

NOTE: If using printed cardstock, keep in mind the direction of the print and how it will appear on the final card design.
This 5 x 7 card size gives you room to add a small pocket behind the left 3-inch section that you can slip in a gift card.

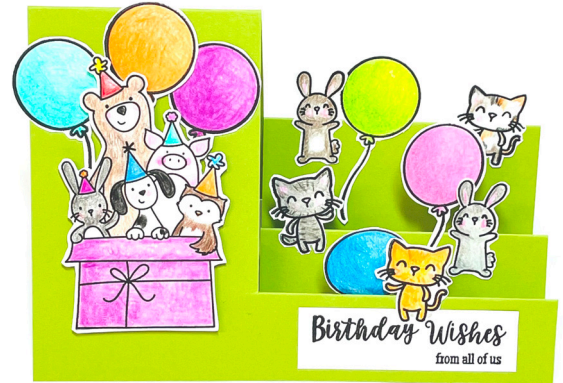

INSTRUCTIONS



1. Place the cardstock onto the paper trimmer with the 7-inch edge along the top. Line up the left edge at the 3-inch mark.

Place the trimmer blade at the 1 1/4-inch mark on the cutting guide, cut to the 7 3/4-inch mark, creating a slit.

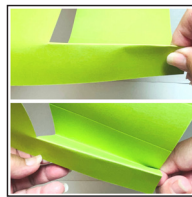

5. On the right side or 4-inch section, you will fold the scored lines like an accordion. Start with folding the first 1 1/4-in. section at the bottom scored line down.

Then, fold the second line up.



2. Place the cardstock onto the Score Board with the 10-inch edge along the top and the 4-inch section topside.

The first and last lines to score match where the slit starts and ends. Align the cardstock to match and score at the following marks: 1 1/4-in., 2 1/2-in., 4-in., 5 1/2-in. and 7 1/4-in.

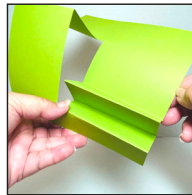

6. Continue the accordion folding with the rest of the scored lines.



3. Now score the 3-inch section at the 5-inch mark. Score only from the edge to the slit.

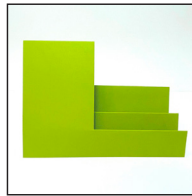

7. After the last fold, you will end up with the card base having a three-tiered folded section on the right.



4. Start folding the card – On the left 3-inch side of the card base, fold down at the 5-inch scored line.



8. Embellish the card as desired. Because of the tiered layers, you can add a lot of dimensions to the card. The card is great for displaying. If you keep the embellishments below the height of the top left edge, you will be able to place the card in a standard envelope.



Follow us for
more inspiration!