



SUPPLIES:

- Hearty® clay, choice of colors
 - Crafty foam cone shape
 - 18 gauge floral wire • Leaf mold
- Optional:**
- Color Scale
 - Cling wrap or Resealable plastic bag

INSTRUCTIONS:



1. Mix clay to desired color. Insert floral wire into the foam shape.



2. To make petals; roll clay into teardrop shape and place clay in your palm.

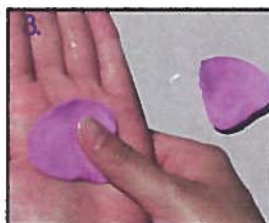

3. Spread the clay evenly across your palm in a fan shape. Make 5 petals.



4. Place the first petal on the foam 1/8" above the tip of the foam, making sure the thin edge is facing up.



5. Place the second petal slightly higher than the first petal.



6. Place the rest of the rose petals and form a rosebud.



7. Continue to make more petals and add it to the rose.



8. To make leaves; roll clay into teardrop shape, slightly flatten. Place clay on the leaf mold and flatten.



9. Attach leaves to the the rose.

No portion of design or written instructions may be reproduced in any form. The information on this instruction sheet has been tested and is presented in good faith, but no warranty is given, nor are results guaranteed. Claycompany.com disclaims all liability from any injury or unsatisfactory results. Warning: Due to the components used in this craft, children under 5 years of age should not have access to materials or supplies.